

Maxi Sky 2 Plus

The **complete** ceiling lift system

ARJOHUNTLEIGH
GETINGE GROUP

A twin cassette ceiling lift system for patients up to 454 kg/1000 lbs



...with people in mind

A **versatile ceiling lift system** for bariatric patients and the general population

Maxi Sky® 2 Plus is a cost-efficient solution, as the system can handle a large range of patients. Using twin lift cassettes mounted on a rotatable trolley, this easy-to-use system enables patients up to 454 kg/1000 lbs to be lifted, transferred, turned and repositioned.



A **ceiling lift solution** for all patient handling routines

The *Maxi Sky 2 Plus* and spreader bar combination makes it possible to use the Dynamic Positioning System for all patients, making patient handling routines comfortable and requiring less effort for the caregiver. The spreader bar's telescopic adjustment feature ensures stability, easy manoeuvring and automatic adjustment to the patient's size and position.

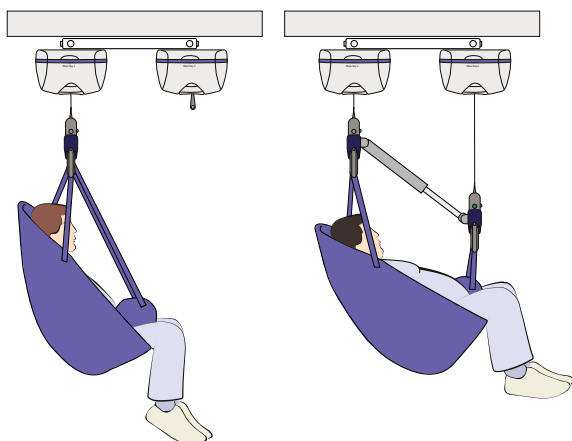

Single mode: One cassette is used when handling non-bariatric patients.

Dual mode: The twin cassettes support smooth repositioning of bariatric patients.

A flexible system for all patients

After a simple switchover to a single cassette, the ceiling lift system is ready to serve non-bariatric patients. In single mode, the system can work as a standard Maxi Sky® 2, utilizing the full range of spreader bars and slings.



The tilt function enables the caregiver to easily place the patient into a seated upright position just before reaching the chair.



All tasks can be performed with the same spreader bar system such as limb support, repositioning as well as transfers.



Thanks to the new tilt function, one spreader bar can be raised to avoid intrusion for the patient and the care giver.

Small details make the **difference**



Self adjustment for patient comfort

Thanks to the telescopic link and the tilting of the two cassettes mounted on the rotating trolley, the system will easily adjust to maximize comfort to the patient.



Maximize patient comfort with a single touch of a button

The tilt function system enables you to raise/lower one of the spreader bars and thereby placing the patient in a more comfortable position during the transfer.



Key data at a glance

The colour display provides information on battery status, monitoring of product usage and smart self-diagnosis for efficient maintenance.

Easy access to equipment

Maxi Cart™ 2 gives you easy access to your spreader bars and stretcher frames. As caregivers can connect them directly from the trolley to the lift, there is no manual lifting involved.

Easy to manoeuvre

Carrying twin lift cassettes, the *Maxi Sky 2 Plus* trolley is rotatable through 360°, which means no patient is a challenge to manoeuvre.

Smooth loop sling attachment

Spring-loaded latches, along with large hook confinements, facilitate the adding and removing of multiple sling loops, increasing the efficiency of care.

Total control at all times

The ergonomically designed IPX7-approved handset features high-durability push buttons for a long service life and easy to clean.

Rapid spreader bar changeovers

In just three simple steps, *Quick Connect* allows the caregiver to switch easily between the spreader bars in our complete range to meet each patient's specific care needs.



A full range of slings and spreader bars means safe, **optimized working routines**

ArjoHuntleigh offers a complete range of clip and loop slings and related spreader bars to provide comprehensive solutions for transfers, repositioning and rehabilitation.



The new spreader bar system enables simplified transfers and increased comfort to the patient

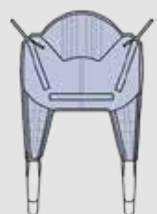

Bariatric Sling MAA8000

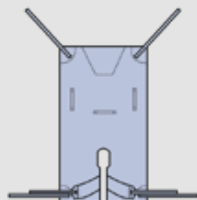

Bariatric Sling MAA8020



**Bariatric Repositioning sling
(washable or disposable)**

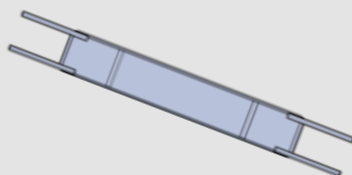

**Bariatric Limb sling
(washable)**

Dual mode spreader bar

One solution, a four point spreader bar, for patients from 159 kg/350 lbs up to 454 kg/1000 lbs, supports the range of bariatric slings.

The different body shapes of bariatric patients require different sling solutions. ArjoHuntleigh has therefore developed a range of sling types in four bariatric sizes to suit these various needs. A patient assessment that covers weight, body shape and the individual's condition is needed in order to select an optimized sling solution that ensures safety and maximum comfort.

With Maxi Sky 2 Plus in **single mode**, the general population can also be addressed

Loop slings

Arjohuntleigh offers a wide range of loop slings for two point and four point spreaders as well as for the stretcher frame.

Clip slings

Clip slings include standard Padded and Unpadded Slings, Special Purpose Slings for toileting, Mesh Slings for bathing and showering, and solutions for single and double amputees.

Flites

Flites® are patient-specific slings that offer protection against the risks associated with cross contamination.

Tailor Made Sling Service

ArjoHuntleigh has the expertise to modify all aspects of its slings to create the optimum sling for a particular patient.



One lift cassette can easily be deactivated and the remaining cassette will function as a normal *Maxi Sky 2* addressing the general population.

Spreader bars for **Single Mode**



Medium 2-point



Small 2-point



Stretcher frame



Large 4-point



Flat manual 4-point DPS



Medium 4-point PDPS
Also available in large 4-point PDPS
and manual 4-point DPS

KWIKtrak Solutions for **every ceiling** and room layout

KWIKtrak™ modular components are used to create an optimized track for *Maxi Sky 2 Plus*. This flexible system covers all layout requirements, and solutions are available for every type of ceiling.



Curtain pass through

Curtains can pass through a "gap" in the track, which improves options for maintaining patient privacy and dignity.



Gate

This connects a fixed track to an X-Y traverse system.



Embedded solutions

Embedded KWIKtrak is mounted into the ceiling, which enables a more discreet look, as well as increasing the lifting stroke.

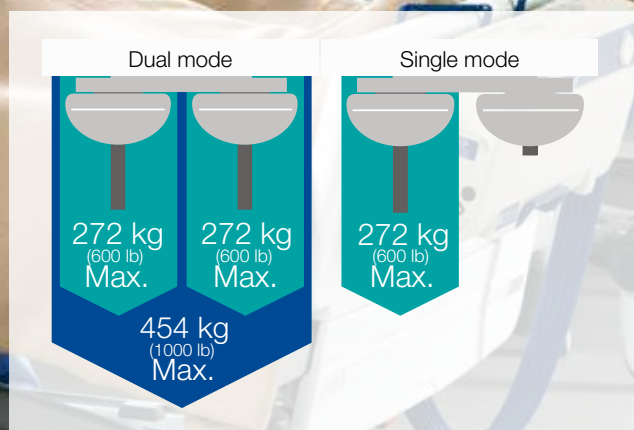

Common **installation** layouts



Straight track tracking solution
A simple straight track configuration provides access for transfers on each side of the patient bed.



X-Y tracking solution
An X-Y tracking solution provides full room coverage. A transfer can be performed anywhere within the two parallel tracks.



X-Y (single gate tracking solution)
An X-Y tracking solution providing full room coverage within the patient's room combined with a Single Gate system and tracking leading into the en-suite bathroom.



Two X-Y (Double Gate) solution
Full-room coverage in both the patient's room and the en-suite, linked together with a straight track configuration using a Double Gate system.

Space requirement for a bariatric room



Make the work easier and more efficient
This image, taken from ArjoHuntleigh Guidebook, provides recommendations on space requirements and what to consider when designing a bariatric room to secure best possible safety and working conditions.

Product Specifications

Weight, complete (incl. trolley and two ceiling lifts)	51.6 kg (113.5 lb)
Weight, spreader bar	6.6 kg (14.5 lb)
Lifting capacity	Dual Mode: 454 kg (1000 lb), Single Mode: 272 kg (600 lb)
Strap length	2500 mm (98.4 in)
Lifting speed (Dual mode)	4.3 cm/s (1.7 in/s) without load 3.5 cm/s (1.3 in/s) at 240 kg (528 lb) 3.0 cm/s (1.2 in/s) at 400 kg (880 lb) 2.9 cm/s (1.1 in/s) at 454 kg (1000 lb)
Maximum stroke (from ceiling)	2300 mm (90.6 in)
Horizontal displacement speeds	N/A, manually operated
Operating force of control	< 5 N
Push and pull forces at 454 kb (1000 lb) Horizontal Movement and Rotation	< 60 N
Duty cycle	Up/Down Motor: Max 10%, 1 minute continuously Sit/Reclined Motor (single mode): Max. 10%, 1 minutes continuously
Horizontal axis motor	N/A
Vertical axis mode	24 VDC, 110 watts
Rating	24 VDC, 15 A max.
Noise level for either raising or lowering, with or without load	58.2 dBA with no load, 65.3 dBA at 454 kg (1000 lb)
Medical equipment	Type BF protection against electrical shock in accordance with IEC 60601-1
Battery type	12 V, 5 Ah, sealed rechargeable valve regulated lead acid battery
Battery capacity	Provides up to 50 transfers with a load of 400 kg (880 lb) and up to 34 transfers with a load of 454 kg (1000lb)
Degree of protection - Hand control	IPX7
Degree of protection - Maxy Sky 2 ceiling lift	IP24
Lift - Protection class - Shock prevention	Internally powered equipment
Battery charger input	100-240 VAC, 50-60 Hz, 57 – 70 VA
Battery charger output	28.1 VDC, 1 A max, 28.1 VA
Battery charger safety protection	Class 2, double insulated
Normal Operation conditions	Ambient temperature range: 5°C to 40°C (41°F to 104°F) Relative humidity range: 15% to 93% Atmospheric pressure range: 700 hPa to 1060 hPa
Transport/Storage conditions	Ambient temperature range: -40°C to 70°C (-40°F to 158°F) Relative humidity range: 10% to 93% Atmospheric pressure range: 500 hPa to 1060 hPa

Mobility Gallery



Suitable for Doris and Emma

D Doris, who has no capacity to support herself.

E Emma, who is almost completely bedridden and totally dependant.

Please contact ArjoHuntleigh for further information on the Mobility Gallery™.

Approvals and list of Standards



Canadian Standards Association:
CAN/CSA C22.2 No.601.1-M90 (AM1+AM2), UL60601-1
(1st ed.) et IEC60601-1 (2nd edition)

CAN/CSA C22.2 No.60601-1-08, ANSI/AAMI ES60601-1:2005 et IEC60601-1:2005



Technischer Überwachungs-Verein:
ISO 10535 : 2006 standard

Maxi Sky 2 Plus: A **great addition** for bariatric care and handling patients of all sizes.

My **performance**



I can perform my tasks more efficiently and in a safe manner

My **comfort**



I can be moved in a more comfortable way

My **budget**



With *Maxi Sky 2 Plus* we can maximize the usage of all rooms

ARJOHUNTLEIGH
GETINGE GROUP

Only ArjoHuntleigh designed parts, which are designed specifically for the purpose, should be used on the equipment and products supplied by ArjoHuntleigh. As our policy is one of continuous development we reserve the right to modify designs and specifications without prior notice.

© and ™ are trademarks belonging to the ArjoHuntleigh group of companies.
© ArjoHuntleigh, 2015

📍 ArjoHuntleigh AB, Hans Michelsensgatan 10, 211 20 Malmö, Sweden
Phone: +46 (0) 10 335 45 00

www.ArjoHuntleigh.com

GETINGE GROUP

Getinge Group is a leading global provider of products and systems that contribute to quality enhancement and cost efficiency within healthcare and life sciences. We operate under the three brands of **ArjoHuntleigh**, **Getinge** and **Maquet**. **ArjoHuntleigh** focuses on patient mobility and wound management solutions. **Getinge** provides solutions for infection control within healthcare and contamination prevention within life sciences. **Maquet** specializes in solutions, therapies and products for surgical interventions, interventional cardiology and intensive care.